



HOUSE of REPRESENTATIVES

STATE OF MICHIGAN

Appropriations Requests for Legislatively Directed Spending Items

1. The sponsoring representative's first name:
Nancy
2. The sponsoring representative's last name:
Jenkins-Arno
3. The cosponsoring representatives' names. All cosponsors must be listed. If none, please type 'n/a.' A signed letter from the sponsor approving the co-sponsorship and a signed letter from the member wishing to co-sponsor are required. Attach letters at question #9 below.
N/A
4. Name of the entity that the spending item is intended for:
Sam Beauford Woodworking Institute
5. Physical address of the entity that the spending item is intended for:
1375 N. Main Street, Building #41 Adrian, MI 49221
6. If there is not a specific recipient, the intended location of the project or activity:
Adrian, MI
7. Name of the representative and the district number where the legislatively directed spending item is located:
Rep. Nancy Jenkins-Arno, HD 34
8. Purpose of the legislatively directed spending item. Please include how it provides a public benefit and why it is an appropriate use of taxpayer funding. Please also demonstrate that the item does not violate Article IV, S 30 of the Michigan Constitution. The Sam Beauford Woodworking Institute (SBWI) seeks legislative directed spending to triple annual graduate capacity in the next four years. This post-secondary trades college provides education and career opportunities through the artistry of woodworking. Students that complete the college-level program at SBWI receive a credential to help them pursue entrepreneurial opportunities or join the workforce with hands-on experience and craftsmanship necessary to ensure they are qualified for good and high-paying

positions.

9. Attach documents here if needed:

Attachments added to the end of this file.

10. The amount of state funding requested for the legislatively directed spending item.

12000000

11. Has the legislatively directed spending item previously received any of the following types of funding? Check all that apply.

["Private"]

12. Please select one of the following groups that describes the entity requesting the legislatively directed spending item:

Non-profit organization

13. For a non-profit organization, has the organization been operating within Michigan for the preceding 36 months?

Yes

14. For a non-profit organization, has the entity had a physical office within Michigan for the preceding 12 months?

Yes

15. For a non-profit organization, does the organization have a board of directors?

Yes

16. For a non-profit organization, list all the active members on the organization's board of directors and any other officers. If this question is not applicable, please type 'n/a.'

Chairman - Robert Argus , Secretary - Dan Butler, Treasurer - Frank Baker At-Large - Nicki Sharer

17. "I certify that neither the sponsoring representative nor the sponsoring representative's staff or immediate family has a direct or indirect pecuniary interest in the legislatively directed spending item."

Yes, this is correct

18. Anticipated start and end dates for the legislatively directed spending item:

Anticipated Start date is Q1 of 2026, Anticipated completion is 2029

19. "I hereby certify that all information provided in this request is true and accurate."

Yes



Form Revision Date 07/2016

CERTIFICATE OF RENEWAL OF ASSUMED NAME

For use by DOMESTIC NONPROFIT CORPORATION

Pursuant to the provisions of Act 162, Public Acts of 1982, the undersigned execute the following Certificate:

1. The identification number assigned by the Bureau is:

802002574

2. The name of the nonprofit corporation is:

SAM BEAUFORD WOODSHOP

3. The assumed name under which business is to be transacted is:

SAM BEAUFORD WOODWORKING INSTITUTE

4. The registration of the assumed name is extended for a period expiring on December 31st of the fifth full calendar year following the year in which this renewal is filed, unless sooner terminated.

This document must be signed by an authorized officer or agent (corporations); a member, manager, or an authorized agent (limited liability companies); or by a general partner (limited partnerships):

Signed this 12th Day of December, 2023 by:

Signature	Title	Title if "Other" was selected
Luke Barnett	President	

By selecting ACCEPT, I hereby acknowledge that this electronic document is being signed in accordance with the Act. I further certify that to the best of my knowledge the information provided is true, accurate, and in compliance with the Act.

☐ Decline

☒ Accept

MICHIGAN DEPARTMENT OF LICENSING AND REGULATORY AFFAIRS
FILING ENDORSEMENT

This is to Certify that the CERTIFICATE OF RENEWAL OF ASSUMED NAME
for

SAM BEAUFORD WOODSHOP

ID Number: 802002574

to transact business under the assumed name of
SAM BEAUFORD WOODWORKING INSTITUTE

received by electronic transmission on December 12, 2023 ***, is hereby endorsed.***

Filed on December 12, 2023, ***by the Administrator.***

The document is effective on the date filed, unless a subsequent effective date within 90 days after received date is stated in the document.

Expiration Date: December 31, 2028



In testimony whereof, I have hereunto set my hand and affixed the Seal of the Department, in the City of Lansing, this 12th day of December, 2023.

Linda Clegg

Linda Clegg, Director

Corporations, Securities & Commercial Licensing Bureau

Investing in Michigan Talent –

A Vision for Education, Innovation & Opportunity

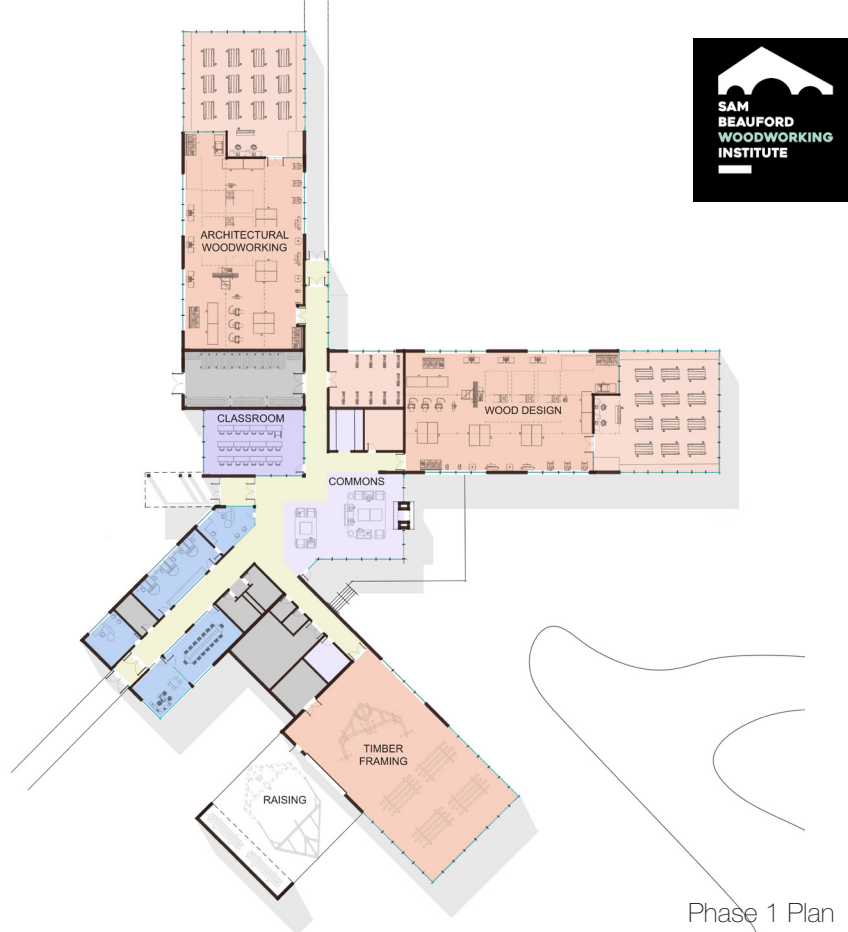

Phase 1 Plan

Requesting \$12 million to fund the \$16 million Phase 1 of an estimated \$48 million 20-year vision.

Vision

- Expand annual graduate capacity from **20 to 60 students in 4 years**, and **200 students in 20 years**, addressing workforce demands.
- Increase diversity by creating more opportunities in Michigan, for **underrepresented groups**.

Opportunities

- Provide **career training** for Michigan's **Forest Products Industry**, filling critical skill gaps.
- Support **workforce development** for the **emerging Mass Timber Industry** and advance sustainable wood products and mass timber initiatives.
- **Demand** for the program far outpaces the number of available seats.
- **Collaborate** with the **Community College Association of Michigan** to establish additional career pathways credentials to move up the ladder.
- **Partnerships** with 4-year institutions for degrees in the forest products field.
- Help increase **Michigan's population** with young talent.

Program Value

- **Affordable**, all-inclusive training: **\$15,110** covers tuition and materials for a diploma.
- Accessible for veterans with **GI Bill funding** available.
- Accredited by the **ACCSC**, ensuring quality education, **Title IV eligible**
- Graduates earn **competitive wages** aligned with **BLS standards** and live a happy, healthy, sustainable lifestyles.
- **2023 Graduates** have a **100% employment rate** that has been third-party verified.

Credibility

- Secured **\$4.2 million in funding**, demonstrating strong institutional backing.
- Have a **20-year vision** with **Phase 1 ready** for construction documentation.
- A **groundswell of community support** documented through letters of support.

Cost Estimate

Construction Costs	Site Clearing & Earthwork	\$ 400,000
	Site Utilities	\$ 650,000
	Drives & Parking	\$ 120,000
	Architectural	\$ 7,487,800
	Mechanical	\$ 1,807,400
	Plumbing	\$ 258,200
	Electrical	\$ 1,936,500
Construction Cost Total		\$ 12,659,900
Soft Costs	Furnishings & Equipment	\$ 2,000,000
	A/E Basic Services	\$ 790,000
	Civil, Testing & Misc.	\$ 120,000
	Owner Contingency	\$ 613,000
Soft Cost Total		\$ 3,523,000
Project Cost Total		\$ 16,182,900

INTERNAL REVENUE SERVICE
P. O. BOX 2508
CINCINNATI, OH 45201

DEPARTMENT OF THE TREASURY

Date:

MAY 19 2017

SAM BEAUFORD WOODSHOP
652 BUDLONG STREET
ADRIAN, MI 49221-0000

Employer Identification Number:
82-1326496
DLN:
26053530003167
Contact Person:
CUSTOMER SERVICE ID# 31954
Contact Telephone Number:
(877) 829-5500
Accounting Period Ending:
December 31
Public Charity Status:
509(a)(2)
Form 990/990-EZ/990-N Required:
Yes
Effective Date of Exemption:
April 25, 2017
Contribution Deductibility:
Yes
Addendum Applies:
No

Dear Applicant:

We're pleased to tell you we determined you're exempt from federal income tax under Internal Revenue Code (IRC) Section 501(c)(3). Donors can deduct contributions they make to you under IRC Section 170. You're also qualified to receive tax deductible bequests, devises, transfers or gifts under Section 2055, 2106, or 2522. This letter could help resolve questions on your exempt status. Please keep it for your records.

Organizations exempt under IRC Section 501(c)(3) are further classified as either public charities or private foundations. We determined you're a public charity under the IRC Section listed at the top of this letter.

If we indicated at the top of this letter that you're required to file Form 990/990-EZ/990-N, our records show you're required to file an annual information return (Form 990 or Form 990-EZ) or electronic notice (Form 990-N, the e-Postcard). If you don't file a required return or notice for three consecutive years, your exempt status will be automatically revoked.

If we indicated at the top of this letter that an addendum applies, the enclosed addendum is an integral part of this letter.

For important information about your responsibilities as a tax-exempt organization, go to www.irs.gov/charities. Enter "4221-PC" in the search bar to view Publication 4221-PC, Compliance Guide for 501(c)(3) Public Charities, which describes your recordkeeping, reporting, and disclosure requirements.

SAM BEAUFORD WOODSHOP

Sincerely,

Stephen a. martin

Director, Exempt Organizations
Rulings and Agreements

REGISTRATION #:
57408



DANA NESSEL
ATTORNEY GENERAL

EXPIRATION DATE:
7/31/2025

Sam Beauford Woodshop
1375 North Main Street
Suite 41
Adrian, MI 49221

This is your current

CHARITABLE SOLICITATION REGISTRATION

Sam Beauford Woodshop

- **The renewal form for this registration is due 30 days prior to above expiration date.** The Renewal Solicitation Form is available on the Attorney General Charitable Trust's website www.mi.gov/charity.
- **Extension** of the registration may be requested if required information will not be available prior to the renewal due date. A written request must be received on or before the above expiration date. If granted, a new expiration date will appear on our searchable database at www.mi.gov/charity. Notification will **not** be sent.
- **Throughout the year**, notify us within 30 days of changes in the following:
 - Address, or your name and any other names used
 - Board of directors or resident agent
 - Any information that appears on your organization report on our searchable database at www.mi.gov/charitysearch.
 - Ceasing operations or merging with another organization
- Submit any **contracts** you enter into with professional fundraisers within 10 days of execution. Charities must verify the licensure of their professional fundraisers. Licensure can be verified at www.mi.gov/charitysearch.
- **The Attorney General Registration number listed above must be referenced on all documents.**

Charitable Trust Section
P.O. Box 30214
Lansing, MI 48909

Phone: 517-335-7571
Fax: 517-241-7074
Email: ct_email@mi.gov
Website: www.mi.gov/charity

ATTENTION

Sam Beauford Woodshop

REGISTRATION# 57408

The Michigan Attorney General's Charitable Trust Section has introduced a new online searchable database. The database provides information regarding organizations that have applied for or hold a current Charitable Solicitation Registration, Professional Fundraiser License, or Public Safety Registration. The public will be able to search and view a variety of fields, including name, purpose, file number, EIN, and location. Once an organization is located, extensive information is available from our database.

We want to provide organizations an opportunity to review the purpose statement on file with this office. Below is the most current summary of your purpose or mission statement:

The Sam Beauford Woodworking Institute provides outcome-based woodworking education with a commitment to ongoing assessment and continuous improvement.

If the above statement is still accurate, you don't need to do anything! If your purpose statement needs to be updated, please summarize your current purpose statement in the space below in **50 words or less**. Please make a copy for your records and return the corrected information to:

Charitable Trust Section
P.O. Box 30214
Lansing, MI 48909
Fax: 517-241-7074

Alternatively, you may email the updated summary to **ct_email@michigan.gov**. Include in the body of your email the name of your organization and the registration number.

Updated Purpose Statement: _____

Please review your organization's information and advise us immediately of any errors. To preview the information, go to: **www.mi.gov/charitysearch**. Please call the Charitable Trust Section if you have any questions at 517-335-7571.



34TH DISTRICT
P.O. BOX 30014
LANSING, MI 48909-7514

MICHIGAN HOUSE OF REPRESENTATIVES
NANCY JENKINS-ARNO
STATE REPRESENTATIVE

PHONE: (517) 373-8808
FAX: (517) 373-5997
NancyJenkinsArno@house.mi.gov

March 13th, 2025

To Whom it may concern,

I'm writing this letter in support of a Legislative Directed Fund for the Sam Beauford Woodworking Institute (SBWI) in the amount of \$12,000,000. This investment will lead directly to increasing Michigan's workforce. It is also a short-term investment that will create a lasting impact in our State and for the growing mass timber industry.

With the requested funding, SBWI is expected to expand its annual graduate capacity from 20 to 60 students in 4 years, and 200 students in 20 years, which will address ever increasing workforce demands. Given the high demand for this program, the institute does not have enough seats available for incoming students. Even with the additional construction of the institute and the increase in student enrollment, the program will remain affordable for Michiganders and will provide them with a sustainable career and a competitive wage.

In addition, the institute plans to work with the Community College Association of Michigan to develop additional career pathway credentials. The improvement will also allow SBWI to partner with four-year institutions for degrees in the forest products field, providing more Michiganders with the ability to enter this field with the intent of developing a lifelong career.

I strongly support the Sam Beauford Woodworking Institute's request. It is the kind of investment we should be making in our communities and in our state. We must remain economically competitive and SBWI will have a direct impact on the specialty woodworking profession in the State of Michigan and will add value to our Michigan heritage.

Should you have any questions, please feel free to reach out to my office at nancyjenkinsarno@house.mi.gov or call 517-373-8808.

Sincerely,

Nancy Jenkins-Arno
State Representative
District 34

LENAWEE COUNTY BOARD OF COMMISSIONERS

301 N. Main St. Courthouse ~ Adrian, MI 49221

CHAIR

James Van Doren

(517) 264-4508

www.lenawee.mi.us

Dawn Bales

Karol "KZ" Bolton

Terry Collins

Nancy Jenkins-Arno

Kevon Martis

Ralph Tillotson

David Stimpson

VICE-CHAIR

Dustin Krasny



PRO#2024-020

Proclamation in Support of the Sam Beauford Woodworking Institute and its Enrollment Growth Project

WHEREAS, Lenawee County is committed to fostering educational excellence, supporting workforce development, and encouraging community growth through diverse and innovative educational opportunities; and

WHEREAS, the Sam Beauford Woodworking Institute (SBWI) has demonstrated a commitment to providing high-quality educational programs in the forest products industry, carpentry, furniture design, and related fields, significantly contributing to the economic and cultural development of Lenawee County; and

WHEREAS, SBWI is accredited by the Accrediting Commission of Career Schools and Colleges (ACCSC), a recognized accrediting agency of the U.S. Department of Education, and offers structured curricula, qualified instruction, and recognized certifications, fulfilling the criteria of an educational institution; and

WHEREAS, the growth and expansion of SBWI's programs enhance the educational landscape of Lenawee County, promote workforce readiness, and support economic development by equipping students with valuable skills in artisan trades and technical fields; and

WHEREAS, SBWI's Enrollment Growth Project aims to expand the institute's capacity to educate more students, further increasing access to education and workforce development opportunities that benefit the entire community;

NOW, THEREFORE, the Lenawee County Commission proudly recognizes the Sam Beauford Woodworking Institute for its outstanding contributions to education, workforce development, and community growth. The Commission expresses its support for SBWI's Enrollment Growth Project and commends its efforts to enhance educational opportunities and strengthen the County's economy through innovation and skilled trades training. Lenawee County remains steadfast in its support of initiatives that enrich our community and advance the goals of higher education and vocational excellence.

PASSED BY ROLL CALL VOTE of the Lenawee County Board of Commissioners at a regular meeting held Wednesday, December 11, 2024 in Adrian, Michigan.

A handwritten signature in black ink, appearing to read "JVD", is written over a horizontal line.

James E. Van Doren, Chair

A handwritten signature in black ink, appearing to read "Roxann Holloway", is written over a horizontal line.

Roxann Holloway, County Clerk



CR25-005

January 21, 2025

RE: CITY COMMISSION – Support for the Sam Beauford Woodworking Institute Enrollment Growth Project.

RESOLUTION

WHEREAS, the City of Adrian recognizes the significant contributions of the Sam Beauford Woodworking Institute (SBWI) in providing exceptional educational programs, vocational training, and promoting the arts, trades, & forest products industry within the community; and

WHEREAS, SBWI is undertaking an Enrollment Growth Project aimed at expanding its capacity to educate more students, thereby enhancing educational opportunities, workforce development, and economic growth within the City; and

WHEREAS, supporting SBWI's Enrollment Growth Project aligns with the City's commitment to fostering educational excellence, economic development, and cultural enrichment; and

WHEREAS, the expansion of SBWI through the Enrollment Growth Project will have a positive impact on the community by increasing access to education, creating job opportunities, and promoting artisan skills;

NOW THEREFORE BE IT RESOLVED, that the Adrian City Commission resolves as follows:

1. That the City of Adrian hereby expresses its full support for the Enrollment Growth Project being carried out by the Sam Beauford Woodworking Institute.

Moved by: **Commissioner Behnke**

Seconded by: **Commissioner Castleberry**

The motion to adopt the resolution was approved by a 7-0 roll-call vote.

STATE OF MICHIGAN)

ss

COUNTY OF LENAWEE)

I hereby certify that the above is a true and complete copy of a resolution adopted by the City Commission of the City of Adrian, County of Lenawee, State of Michigan, at a Regular Meeting held on January 21, 2025 and that public notice of said meeting was given pursuant of Act No. 267, Public Acts of Michigan, 1976, including in the case of a special or rescheduled meeting, notice by publication or posting at least eighteen hours prior to the time set for the meeting.

Christy Low

City Clerk

Adrian, Michigan

Dated this 22nd day of January, 2025

CR25-004

January 21, 2025

RE: CITY COMMISSION – Recognition of the Sam Beauford Woodworking Institute as an institution of higher education.

RESOLUTION

WHEREAS, the City of Adrian is committed to fostering educational excellence and supporting institutions that provide higher education opportunities to its residents; and

WHEREAS, two distinguished institutions of higher learning—Adrian College and Siena Heights University—are currently headquartered in the City; and

WHEREAS, the Sam Beauford Woodworking Institute (SBWI) has demonstrated a commitment to providing comprehensive educational programs in the forest products industry, carpentry, furniture design, and related fields; and

WHEREAS, SBWI meets the criteria of an educational institution by offering structured curricula, qualified instructors, and recognized certifications; and

WHEREAS, SBWI meets the criteria of an educational institution by institutional and programmatic accreditation through The Accrediting Commission of Career Schools and Colleges (ACCSC), a recognized accrediting agency through the U.S. Department of Education; and

WHEREAS, recognizing SBWI as a college enhances the educational landscape of Adrian, promotes diversity in educational offerings, and contributes to the city's reputation as a center for learning and the arts;

NOW THEREFORE BE IT RESOLVED, that the Adrian City Commission resolves as follows:

1. That the City of Adrian hereby formally recognizes the Sam Beauford Woodworking Institute as a third college with its principal place of operations within the City of Adrian.
2. That the City supports the ongoing efforts of SBWI to provide quality higher education and encourages collaboration between it and other educational institutions and community organizations.

Moved by: Commissioner Miller
Seconded by: Commissioner Roberts

The motion to adopt the resolution was approved by a 7-0 roll-call vote.

STATE OF MICHIGAN)

ss

COUNTY OF LENAWEE)

I hereby certify that the above is a true and complete copy of a resolution adopted by the City Commission of the City of Adrian, County of Lenawee, State of Michigan, at a Regular Meeting held on January 21, 2025 and that public notice of said meeting was given pursuant of Act No. 267, Public Acts of Michigan, 1976, including in the case of a special or rescheduled meeting, notice by publication or posting at least eighteen hours prior to the time set for the meeting.

A handwritten signature in cursive script, reading "Christy Low", is displayed within a rectangular area with a light gray dotted background.

Christy Low

City Clerk

Adrian, Michigan

Dated this 22nd day of January, 2025



CR24-128

November 18, 2024

**RE: ADMINISTRATION – OPTION FOR THE SALE OF PROPERTY TO SAM BEAUFORD
WOODWORKING INSTITUTE**

RESOLUTION

WHEREAS, at a work session discussion held on November 4, 2024, the Adrian City Commission discussed the terms of an option agreement for the purchase and sale of a portion of the Witt farm property to the Sam Beauford Woodworking Institute; and

WHEREAS, the parties exchanged and agreed upon a Term Sheet incorporating the elements of the proposed option agreement; and

WHEREAS, the City Administrator recommends approval of an option agreement for the sale of approximately 21.25 acres of land as described in the said term sheet to the Sam Beauford Woodworking Institute, with the sale price for that portion of the land that was historically farmland to be \$8,000 per acre and the sale price for the balance of the land, currently wooded, to be \$10 per acre; and

NOW, THEREFORE, BE IT RESOLVED that the Adrian City Commission, by this resolution, approves the City's entry into an option agreement for the sale of land on the terms described in the said term sheet and herein, in a form acceptable to the City Attorney; and

BE IT FURTHER RESOLVED, that the Adrian City Commission authorizes the City Administrator to execute the option agreement and to do each and every thing necessary to effectuate the sale of that certain land, as provided for in the option agreement, and to execute a deed and any other required closing documents for the sale of the said land, on behalf of the City, according to the terms provided for herein.

Moved by: Commissioner Roberts
Seconded by: Commissioner Castleberry

The motion to adopt the resolution was approved by a 7-0 roll-call vote.

STATE OF MICHIGAN)

ss

COUNTY OF LENAWEE)

I hereby certify that the above is a true and complete copy of a resolution adopted by the City Commission of the City of Adrian, County of Lenawee, State of Michigan, at a Regular Meeting held on November 18, 2024 and that public notice of said meeting was given pursuant of Act No. 267, Public Acts of Michigan, 1976, including in the case of a special or rescheduled meeting, notice by publication or posting at least eighteen hours prior to the time set for the meeting.

A handwritten signature in cursive script, reading "Christy Low", is displayed within a rectangular area with a light gray dotted background.

Christy Low
City Clerk
Adrian, Michigan
Dated this 22nd day of January, 2025

MICHIGAN STATE UNIVERSITY

December 12, 2024

To Whom It May Concern,

I am pleased to offer my support for the Enrollment Growth Project at the Sam Beauford Woodworking Institute (SBWI). This expansion of SBWI's footprint and capacity aligns with the objectives of MassTimber@MSU, a program I lead at Michigan State University dedicated to advancing mass timber construction and manufacturing in Michigan and the broader region through outreach, communications, education, research, policy, and partnerships. Our network comprises hundreds of practitioners and stakeholders—including architects, engineers, contractors, policymakers, academics and forest managers—united in pursuing a shared vision: to make mass timber a cornerstone of sustainable construction and economic vitality in the Great Lakes region.

The Enrollment Growth Project supports the evolving needs of our network. Once operational, the expanded program will equip students, contractors, engineers, and architects with the specialized skills needed to confidently source, design, fabricate, and install mass and heavy timber components.

This workforce development focus is essential. Widespread adoption of mass timber is not only about choosing a more sustainable building material—it's also about ensuring we have the skilled professionals to translate that potential into real projects that support forest health, strengthen local manufacturing, and advance community resilience. The Enrollment Growth Project places an emphasis on engaging underserved and underrepresented populations, helping ensure that the benefits of a growing mass timber market are shared equitably. This is especially vital as our region seeks sustainable economic development strategies that center on locally sourced, renewable resources and inclusive opportunity.

In my two decades working at the intersection of climate action, sustainable resource policy, and equitable community development, I have seen firsthand that combining workforce readiness, educational excellence, and industry engagement can transform emerging markets into thriving, resilient sectors. The Enrollment Growth Project aims to create exactly these conditions—preparing the way for a world-class training environment that will not only elevate mass timber expertise in Michigan but also help propel the entire industry forward.

MassTimber@MSU is committed to collaborating with organizations like SBWI that share our vision for a robust, sustainable mass timber sector. I am excited about the potential for the Enrollment Growth Project to yield lasting positive impacts for the region's economy, workforce, and forests.

Thank you for your consideration.

Sincerely,

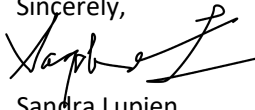

Sandra Lupien

Director, MassTimber@MSU

lupien@msu.edu/510-681-3171



College of
**Agriculture
and Natural
Resources**

Department of Forestry

Natural Resources Building
480 Wilson Road, Room 126
East Lansing, MI
48824-1222

Telephone: 517 / 355-0090
Fax: 517 / 432-1143



Adrian College

OFFICE OF THE PRESIDENT

October 3, 2024

To Whom It May Concern,

I am writing to express my strong support for the Sam Beauford Woodworking Institute and to highlight its significant impact on economic development in Adrian and Lenawee County. This institution has demonstrated not only a deep commitment to craftsmanship but also a remarkable ability to contribute to the local economy and the broader community. As a key educational institution in Adrian, Adrian College is encouraged by the synergy that exists between our mission and that of the Sam Beauford Woodworking Institute, and we are open to exploring future collaborations.

The Sam Beauford Woodworking Institute, under the leadership of its founder, Luke Barnett, has established a successful track record of growth and achievement. The Institute has grown into a prominent destination for individuals seeking to acquire woodworking skills, and its current enrollment speaks volumes about its success. The fact that the Institute is operating at full capacity, with a waiting list of 50 students from across the United States, is a testament to its national reputation and appeal. As an accredited 501(c)(3) nonprofit organization, it plays a crucial role in providing educational and vocational opportunities while promoting a culture of artisanship that is increasingly valued in today's world. Furthermore, the Institute's seven full-time employees underscore its role as a contributor to job creation and workforce development in Lenawee County.

The Institute's ability to attract students from all over the country is a major boon to the local economy. By drawing students, visitors, and instructors to the region, the Sam Beauford Woodworking Institute helps to stimulate local businesses, increase demand for housing, and promote tourism in our community. Adrian has long been known as a college town, and institutions like the Sam Beauford Woodworking Institute only enhance that reputation. By providing hands-on, skill-based education in a specialized field, the Institute brings a diverse demographic to the area—one that complements the academic environment fostered by Adrian College.

What excites Adrian College most about the Sam Beauford Woodworking Institute, however, is the immense potential for collaboration. The educational model employed by the Institute aligns closely with the experiential learning and hands-on opportunities that are central to the type of education we provide. Adrian College firmly believes that there are numerous possibilities to work together in the

future, particularly in the development of a credit-bearing academic program that merges practical craftsmanship with academic rigor. Such a program would benefit both institutions, offering students a comprehensive learning experience that marries the intellectual pursuits of a liberal arts education with the tangible skills needed in the woodworking and trades sectors.

As we look to the future, Adrian College remains open to exploring the many ways we can collaborate with the Sam Beauford Woodworking Institute. Luke Barnett and his team have built something truly special, and we are eager to find ways to build on that success, both for the benefit of our students and for the broader Lenawee County community. The combination of educational innovation, economic development, and skilled craftsmanship makes the Sam Beauford Woodworking Institute a valuable asset, and Adrian College is proud to support its ongoing work.

Sincerely,

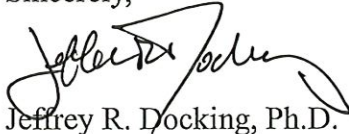
A handwritten signature in black ink, appearing to read "Jeffrey R. Docking", written over a horizontal line.

Jeffrey R. Docking, Ph.D.
President



GRETCHEN WHITMER
GOVERNOR

STATE OF MICHIGAN
DEPARTMENT OF NATURAL RESOURCES
LANSING



M. SCOTT BOWEN
DIRECTOR

October 28, 2024

Adrian City Commission
Adrian City Hall
135 E. Maumee St.
Adrian, Michigan 49221

Dear Adrian City Commissioners:

SUBJECT: Support for the SBWI Enrollment Growth Project

I am writing to express my strong support for the Enrollment Growth project by the Sam Beauford Woodworking Institute for the development of their expanded campus. This initiative not only aims to bolster educational opportunities but also offers significant long-term benefits to Michigan's natural resources, economic development, and sustainable forestry practices.

As you may be aware, Michigan's natural resources are not only pivotal for our ecological health but also serve as a keystone for economic vitality. The expansion of the Woodworking Institute promotes the importance of skill development in woodworking—a craft that not only honors traditional practices but also aligns well with contemporary sustainable approaches, such as mass timber utilization. By investing in educating the next generation of woodworking professionals, we foster a skilled workforce that is knowledgeable about the sustainable management and utilization of our forest resources.

This proposed land sale will play a crucial role in empowering local artisans and encouraging the advancement of woodworking skills—including innovative technologies and practices to effectively harness and utilize fast-growing species of trees. Mass timber, which is gaining traction as a sustainable building material, relies heavily on skilled woodworking professionals who can not only design and implement wood structures but also prioritize sustainability in their work. The growth of this industry will not only lead to job creation but also support forest management that balances harvested timber with the need to preserve and protect our natural landscapes.

Moreover, the integration of mass timber in the construction of the new institute highlights a move toward innovative and environmentally friendly building methods. Mass timber products significantly lower carbon footprints when compared to traditional construction materials while promoting effective carbon storage. Implementing mass timber showcases commitment to natural resource stewardship and sends a powerful message about sustainable development.

Adrian City Commissioners
Page 2
October 28, 2024

Additionally, the Woodworking Institute can become a vital hub for community engagement, where residents can gain hands-on training and knowledge about sustainable practices, contributing to both economic growth and environmental stewardship. This alignment with the principles of sustainable natural resource management is markedly beneficial, as it helps to ensure that our forests can be utilized responsibly and regeneratively for generations to come.

As an avid woodworker myself, I fully support the institute's request and consider the land sale necessary for the realization of this vision. I believe that by fostering woodworking expertise, we not only strengthen the local economy but also exemplify responsible stewardship of our state's abundant natural resources. I encourage the decision-makers of Adrian to consider the long-term benefits this campus development brings, not only to Lenawee County but to the broader community as well.

Thank you for considering this important advancement for your community and the state of Michigan. Should you wish to discuss this matter further or require any additional information on how we can collaborate to support this initiative, please do not hesitate to reach out.

Sincerely,

A handwritten signature in black ink, appearing to read 'Patrick Mohney', with a long horizontal flourish extending to the right.

Patrick Mohney
Senior Lands Program Manager
Michigan Department of Natural Resources
Office of Public Lands, Executive Division
989-387-8189



State of Michigan
Gretchen Whitmer, Governor

The State of Michigan
Arts and Culture Council
300 N Washington Square
Lansing, Michigan 48913

November 7, 2024

To Whom it May Concern:

I am pleased to express our strong support for the Sam Beauford Woodworking Institute's (SBWI) Enrollment Growth Project. This initiative exemplifies the type of innovative arts and culture programming that aligns with our mission to invest in Michigan's creative ecosystem and enhance community vitality.

MACC's strategic goals emphasize the importance of fostering community enrichment through the arts, economic development, and lifelong arts education. SBWI's project addresses these goals by building an educational environment where students can gain essential skills in fine woodworking and craftsmanship—skills that open doors to 21st-century careers while preserving Michigan's cultural heritage. In the growing industry of forest products, SBWI's students are becoming skilled craftspeople and contributing to an evolving creative economy that benefits the entire state.

Furthermore, MACC believes that initiatives like SBWI's play an integral role in building a strong creative workforce. By training students in both traditional and contemporary woodworking techniques, SBWI nurtures a talent pipeline that supports Michigan's economy and cultural sector. This project will not only draw students and professionals to Adrian but will also help create job opportunities and stimulate economic activity in the area. It's an inspiring example of how local investment in arts and culture can have far-reaching effects on community vitality and statewide economic growth.

We encourage funding support for the SBWI Enrollment Growth Project. In doing so, you are investing in Michigan's future—strengthening our arts education, supporting a resilient creative economy, and enriching the quality of life for all Michiganders. MACC is proud to stand behind SBWI as it works to bring these important benefits to Adrian and beyond.

Respectfully,

Alison Watson, Director
State of Michigan Arts and Culture Council
300 N. Washington Square
Lansing, MI 48913
watsona11@michigan.org
517.275.0579

Alison Watson
Director

Council Members
Gretchen Gonzales
Davidson
Chair
Birmingham

Darryl Brown
St. Ignace

Cézanne Charles
Detroit

Julie Egan
Detroit

Joori Jung
Detroit

Anesa Kramer
Bloomfield Hills

David Kronberg
Marquette

Alanna Maguire
Plymouth

Cindy Meyers Foley
Grand Rapids

Amy Spadafore
Saginaw

Nafeesah Symonette
Grosse Pointe Woods

Esther Triggs
Interlochen

Rhonda Welsh
Troy

Robert Womack
Grand Rapids

Kate Yancho
Kalamazoo





October 2, 2024

Luke Barnett
Sam Beauford Woodworking Institute
1375 N. Main Street Building 41
Adrian, MI

Dear Mr. Barnett,

I want to extend my sincere appreciation for the opportunity to meet with you over the past few weeks to discuss your plans for expanding the Sam Beauford Woodworking Institute. I value the relationship we have built over the years, particularly our shared commitment to skill development and career opportunities for the residents of our region.

The vision you've outlined for the Academy's expansion is truly exciting. The expanded programs and opportunities in woodworking and the wood industries will undoubtedly benefit the Adrian area and Lenawee County. Not only could this foster economic growth, but it would also help cultivate a more skilled workforce around one of Michigan's most important natural resources.

The program opportunities you've shared seem like a natural extension of the skills we already develop at the Lenawee ISD TECH Center, particularly within our Building Trades and Residential Construction programs. These new offerings could provide students with specialized skills and credentials, benefiting not only our LISD students from different Career and Technical Education programs, but individuals from the entire region, state, and beyond. I see a lot of potential in how these programs could dovetail with what we offer, helping students chart their career paths.

Regarding our discussion on property at our TECH Center campus, I regret to inform you that selling any property currently is not an option. As you know, the LISD recently acquired the Jackson College building at 1372 North Main Street, along with over seven acres of additional land. While we are still determining the best use for this space, it will be crucial as we adapt to the evolving demands of our educational programs, especially in Career and Technical Education. For now, we are not considering selling any properties, as physical space remains essential for offering comprehensive educational opportunities.

However, as we discussed, our service drive on the north end of the campus could play a role in your property development plans. We would be open to further discussions around shared use or possibly granting an easement for this service drive. I am excited about the possibilities that lie ahead for the programs you envision, and I believe collaboration could benefit both our organizations.

At Lenawee ISD, we take pride in partnering with higher education institutions in our region to enhance student outcomes and provide meaningful opportunities for residents. I fully support your vision and look forward to future conversations where we can explore ways to support your efforts and partner for the benefit of Lenawee County.

Thank you again for your time, and I look forward to continuing our discussions.

Sincerely,

A handwritten signature in black ink, appearing to read 'Mark Haag', with a stylized flourish at the end.

Mark Haag, Superintendent
Lenawee Intermediate School District (LISD)
mark.haag@lisd.us
517-265-1628



WoodWorks – Wood Products Council
1101 Pennsylvania Avenue, N.W., Suite 300
Washington, DC 20004

December 17, 2024

Review Committee
Wood Innovation Grants 2025

Project: The Enrollment Growth Project

WoodWorks – Wood Products Council supports Sam Beauford Woodworking Institute (SBWI) in their 2025 Wood Innovation Grant application. This project is to complete requirements necessary for a commercial construction project that uses mass timber and heavy timber as the primary building material, including architectural and engineering designs, cost analyses, civil, MEP, and permitting necessary. The commercial construction project is to expand a school's programs to train workforce development for the mass timber and heavy timber industry.

WoodWorks will assist the project team in this endeavor as well as disseminating the result via our social media channels and education events. WoodWorks is in place nationally conducting AEC education and providing project assistance to help increase the use of wood in non-residential and multi-family buildings. Jason Reynolds is the WoodWorks Senior Director overseeing WoodWorks Construction Management Program. Jason will continue to be involved in any synergies between this program and the WoodWorks program.

WoodWorks views this proposal as important as it aligns with and supports the WoodWorks goal of expanding markets for wood products through education and outreach. WoodWorks will engage as needed to help this project be successful.

Sincerely,

A handwritten signature in blue ink, appearing to read "Heather Strong".

Heather Strong, Senior Director – Project Resources & Solutions Division
WoodWorks – Wood Products Council



To whom it may concern,

On behalf of Lenawee Now, I am pleased to offer this letter of support for the Sam Beauford Woodworking Institute's (SBWI) Enrollment Growth Project. This initiative represents a significant opportunity for economic development in Adrian and Lenawee County, and its impact will be felt for many years to come.

The addition of another college in Adrian brings numerous economic benefits to the region. SBWI's unique focus on fine woodworking and skilled trades education, paired with its continuing education courses, will attract students from across the country. These traveling students will contribute to the local economy by utilizing lodging, dining, and other services during their stay, injecting valuable revenue into local businesses. Furthermore, as a college, SBWI will create jobs, both directly and indirectly, as part of its operations and growth.

This project also presents exciting opportunities for collaboration with our local educational institutions, including the LISD Tech Center, Adrian College, Siena Heights University, and the Align Center for Workforce Development. These partnerships will allow for shared resources, expanded program offerings, and innovative joint initiatives that will strengthen Adrian's reputation as a thriving educational hub. The alignment between these institutions will further enhance the region's ability to prepare students for meaningful careers, especially in industries where there is high demand for skilled labor.

In addition to the economic benefits, SBWI's expansion will have a profound impact on students. By providing hands-on, industry-focused education, the institute will help build a robust talent pipeline that supports the local economy. This will not only meet the needs of local employers but will also position Lenawee County as a destination for high-quality, specialized education in the skilled trades. In doing so, we will retain talent in the region, creating a sustainable workforce and further solidifying Lenawee County's role in Michigan's economic future.

I strongly encourage community wide support for the SBWI Enrollment Growth Project and recognize the critical role it plays in driving economic and educational development in our community. The investment in this project is an investment in Lenawee County's future, and we are excited to see the positive outcomes it will bring.

Sincerely,

Patrick Farver
Executive Director

5285 West US-223, Suite A
Adrian, MI 49221

517.265.5141 phone
517.913.6044 facsimile

www.lenaweenow.org





1440 W. Maumee St.
Adrian, MI 49221
517.263.4696
lenaweecf.com

October 21, 2024

To Whom It May Concern,

I am writing to express my enthusiastic support for the Sam Beauford Woodworking Institute (SBWI) and its Enrollment Growth Project. SBWI plays a pivotal role in advancing education, arts, and skilled trades in Lenawee County, and this initiative represents a significant opportunity to strengthen our community's economic and educational landscape.

At the Lenawee Community Foundation, our mission is to enhance the health, happiness, and hope of our citizens. We believe in supporting local projects that meet the needs of today and tomorrow and opening the doors of opportunity to a better future for our community. The SBWI Enrollment Growth Project aligns well with our focus on building a stronger, more prosperous Lenawee. By expanding its educational offerings, SBWI will help prepare individuals for meaningful careers in woodworking, forest products, and the skilled trades, all of which are critical to the economic future of our community.

The impact of SBWI's growth extends far beyond education. It directly addresses several areas central to our Foundation's mission, including health, culture, and community engagement. By fostering hands-on learning and creating career pathways in skilled trades, the project will help retain local talent, build the workforce pipeline, and contribute to economic vitality. Additionally, SBWI's focus on the creative and cultural aspects of woodworking enhances the cultural richness of our community, contributing to Lenawee's reputation as a place where craftsmanship and creativity thrive.

I encourage support for the SBWI and the Enrollment Growth Project. It represents a critical investment in Lenawee's future, addressing both immediate needs and long-term growth opportunities. By fostering education, economic development, and cultural enrichment, this project will have a lasting impact on the health and happiness of our citizens—now and forever.

Thank you for your consideration, and for your continued commitment to the future of Lenawee County.

Sincerely,

A handwritten signature in blue ink that reads "Bronna Kahle". The signature is fluid and cursive, with the first name "Bronna" and last name "Kahle" clearly distinguishable.

Bronna Kahle
CEO & President

For Lenawee's health, happiness, and hope. Now and forever.

October 25, 2024

To Whom it May Concern:

As Superintendent of Adrian Public Schools, my top priority is ensuring that our students have access to the best possible opportunities for their futures. That's why I am so enthusiastic about the Sam Beauford Woodworking Institute and their Enrollment Growth Project. The impact this initiative will have on students in our district—and beyond—is significant and deeply needed.

One of the biggest challenges our students face is finding meaningful, hands-on learning experiences that prepare them for real-world careers. SBWI offers exactly that. Their programs don't just teach carpentry—they provide students with the practical skills, confidence, and creativity needed to thrive in today's workforce. This project will expand those opportunities, allowing even more students to engage in skilled trades education, something that's becoming increasingly rare in traditional schooling environments.

SBWI will give students access to an environment where learning is hands-on and focused on building tangible skills. In a world that's often so focused on abstract concepts, the chance to create something with your own two hands can be incredibly empowering for students. It teaches problem-solving, discipline, and attention to detail—all essential life skills, regardless of career path.

What I find particularly exciting is how this project aligns with the needs of our students. It opens doors for those who might not see themselves in a traditional college setting but still have tremendous potential. SBWI's focus on skilled trades education fills a critical gap, offering a path for students to pursue high-demand careers that are fulfilling and sustainable.

This project also has the potential to inspire a love of learning and craftsmanship that students can carry with them for the rest of their lives. It's about more than just career readiness; it's about fostering a sense of purpose and giving students the tools to succeed in whatever they choose to pursue.

I wholeheartedly support SBWI's Enrollment Growth Project and believe it will make a lasting impact on our students and community. By investing in SBWI, we are investing in the future of our students—giving them the skills and opportunities they need to build successful, rewarding careers.

Sincerely,
Nate Parker
Superintendent, Adrian Public Schools



TIMBER FRAMERS GUILD

299 PRATT RD, ALSTEAD, NH 03602

TEL: 833-862-7376

WEB: www.tfguild.org

10/23/2024

On behalf of the Timber Framers Guild (TFG), I am pleased to offer my support for the Sam Beauford Woodworking Institute (SBWI) and its Enrollment Growth Project. As the Executive Director of the Timber Framers Guild and one of the carpenters fortunate enough to work on the Notre Dame Cathedral restoration, I am deeply aware of the importance of passing down craftsmanship to future generations. SBWI's commitment to hands-on education and its vision for expanding its programs align perfectly with the Guild's mission to advance timber framing through research, education, and the development of skilled carpenters.

The need for well-trained carpenters has never been greater. SBWI plays a crucial role in addressing this challenge by offering students the skills they need to enter the workforce as competent, confident woodworkers.

The Timber Framers Guild has partnered with Luke Barnett and SBWI on numerous occasions with great success. Together, we have been able to advance the craft through workshops and educational programs that serve both professionals and the public. SBWI's commitment to education and its focus on growing the next generation has been invaluable to our shared goals of enriching communities through craft.

By expanding its reach and capacity through the Enrollment Growth Project, SBWI is preparing to meet the increasing demand for skilled carpenters, while fostering a deeper appreciation for the art and science of timber framing. This project will help build the foundation of a sustainable workforce, not only for the timber framing industry but for the broader construction and craft sectors.

I strongly encourage support for SBWI's Enrollment Growth Project. The impact of this initiative will be felt not just locally in Adrian, but across the country as it strengthens the craft of timber framing and helps meet the growing need for skilled tradespeople.

Sincerely,
Jackson DuBois



TIMBER
FRAMERS
GUILD

Jackson B DuBois

Cell: (646) 591-4443

email: ed@tfguild.org

Enriching Community Through Craft



October 28, 2024

To Whom It May Concern:

I'm writing to express my strong support for the Sam Beauford Woodworking Institute and its growth, which has the potential to significantly impact the entrepreneurial landscape of Lenawee County. At Launch Lenawee, our mission is to support and develop local entrepreneurs and small businesses, and I see SBWI's project as a perfect fit for that vision.

SBWI is preparing the next generation of entrepreneurs in the forest products industry. By equipping students with both technical skills and a strong foundation in business, SBWI and Launch Lenawee together, can empower graduates to open their own businesses right here in Lenawee County.

Lenawee County is uniquely positioned to be a prime location for these types of businesses to thrive. We have a rich history of craftsmanship and entrepreneurship, exemplified by Orville and Ruth Merillat, who founded their cabinet business in Adrian, Michigan. There's still additional land available at the Witt Farm, where future SBWI graduates, equipped with both their craft and business skills, could set up their own cabinet shops or furniture shops and continue this tradition of innovation and success.

At Launch Lenawee, we believe in nurturing small businesses, and with the right support—including mentorship, business development services, and access to capital—SBWI graduates will have all the tools they need to build a business in our community. These businesses will not only serve local customers but also attract regional and national attention, helping to make Lenawee County a hub for quality craftsmanship and entrepreneurship.

I wholeheartedly support SBWI's Enrollment Growth Project and look forward to seeing how it will help foster entrepreneurship in Lenawee County. This is an investment in the future of our local economy and in the next generation of skilled craftsmen and business leaders.

If you have any questions, or would like to speak further on this matter, please do not hesitate to contact me at mark@launchlenawee.org or by phone at 517.403.1900.

Sincerely,

Mark Murray
Launch Lenawee Business Mentor
Adrian Armory Community Center, Inc., Treasurer

To whom it may concern,

As the founder of Riverbend Timber Framing, I am writing to express my strong support for the Sam Beauford Woodworking Institute (SBWI) and its Enrollment Growth Project. Over the years, I've witnessed firsthand the challenges our industry faces in finding skilled craftsmen to meet the growing demand for timber framing and related trades.

The shortage of workers is one of the greatest hurdles we encountered. We were forced to take unusual steps to train and recruit skilled personnel. Over the years we conducted 50 onsite timber frame workshops to train and develop timber framers. We also collaborated with the local schools until the schools dropped woodshop classes and drafting classes. We also were cofounders of the Timber Framers Guild based in New Hampshire to conduct education and research in Timber Frame construction. This is where SBWI plays a critical role.

The institute is providing the kind of hands-on, high-quality education that is desperately needed to train the next generation of craftsmen. By expanding their offerings through the Enrollment Growth Project, SBWI will not only help solve the labor shortage but also ensure that the artistry and skills required for timber framing continue to thrive. Michigan has a rich forestry history and a surplus of forest stock which is well suited to timber framing and production of engineered wood materials which are increasingly sought after to satisfy the growing need for sustainable, green construction. The growing demand for timber frame homes and sustainable construction practices means that our industry needs workers who are not only technically skilled but also understand the traditions and precision of working with wood while mastering new manufacturing technologies.

SBWI is uniquely positioned to meet this demand by training students in both the technical aspects of woodworking and the craft itself. Their graduates leave with the experience and expertise needed to step directly into the workforce, and this kind of workforce development is something our industry cannot succeed without. Michigan stands to be a leader in this educational effort as the only degree granting school associated with the Timber Frame Industry.

I strongly encourage you to support the SBWI Enrollment Growth Project. It is a critical investment in the future of skilled trades, and it will have a direct and lasting impact on companies like Riverbend Timber Framing other related companies as well as the broader construction industry.

Frank Baker

Founder



9/4/2024

To Whom It May Concern,

I am writing this letter regarding the support of the Sam Beauford Woodworking Institute.

Recently I was made aware of the opportunity for Luke Barnett and his team to expand their operations and was excited to hear that he wanted to continue to grow his business in Adrian. SBWI is an internationally renowned institute that brings together people from all walks of life into Adrian, MI. In providing such a robust learning facility that attracts a wide population to not only attend the school, but also spend their leisure time and money downtown, they are a true asset to this community. A few weeks back, I was approached by a Veteran who was attending school at the SBWI to not only compliment our operation and what we offer, but also to seek employment while he continues his education at SBWI. This is one of many visitors we have had over the years who have discovered Chaloner's because of their attending the institute. I greatly look forward to seeing the expansion of the Sam Beauford Woodworking Institute, not only for the students it serves, but the community growth that occurs because of them being right here in Adrian.

Please feel free to reach out to me if you have questions or would like to discuss this further.

Sincerely,

Laura L. Wanke
Owner

Chaloner & Co.
Chaloner's Cigar House
108 W. Maumee
Adrian, MI 49221
(517) 263-9803
Laura@chalonerscigarhouse.com
www.chalonerscigarhouse.com

Chaloner's Cigar House 108 West Maumee St. Adrian, MI 49221 (517) 263-9803
www.chalonerscigarhouse.com



Society of American Period Furniture Makers

My name is Dave Redlin, I am the President of the Society of American Period Furniture Makers. I want to express our enthusiastic support for the Sam Beauford Woodworking Institute and its plans to expand through the Enrollment Growth Project. SAPFM believes that true craftsmanship, especially in period furniture making, is as much about preserving history as it is about advancing skill, and SBWI embodies this belief to its core.

There are few places left in America that focus on teaching these traditional techniques with such dedication. SBWI is one of them, and their students are mastering skills that might otherwise be lost to time. These skills require an intensive, hands-on learning environment, and SBWI is leading the way. Their approach goes beyond technical training—it builds appreciation and respect for the artistry, the heritage, and the craftsmanship that define period furniture making.

The Enrollment Growth Project is about building a future for this craft. It's about giving more students the chance to learn, to create, and to carry forward the skills that our members have spent their lives refining.

Supporting SBWI's growth is a way of ensuring that period furniture making remains a respected and valued art form. We wholeheartedly back this project and encourage others to do the same.

Best Regards,

Dave Redlin

President. Society of American Period Furniture Makers